

# HOSE ADAPTER FITTINGS



**Western Valve  
& Fitting**

**(925-443-8500)  
4355 Technology Drive  
Livermore, CA 94551**

# Table of Contents

Male Adapters                      Page 2

Female Adapters                      Page 2

Tube Adapters                      Page 3

Tube Fitting Adapters                      Page 3

# Male Adapter

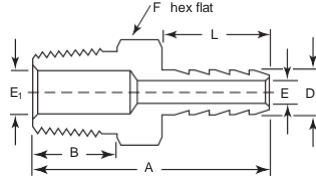

Part No.	End Connections		Dimensions, in.						
	Hose ID	Male NPT	A	B	D	E	E1	F	L
HAFM-2-2N	1/8	1/8	1.08	0.38	0.15	0.08	0.19	7/16	0.40
HAFM-2-4N	1/8	1/4	1.26	0.56	0.15	0.08	0.28	9/16	0.40
HAFM-3-2N	3/16	1/8	1.27	0.38	0.23	0.12	0.12	7/16	0.59
HAFM-3-4N	3/16	1/4	1.45	0.56	0.23	0.12	0.28	9/16	0.59
HAFM-4-2N	1/4	1/8	1.47	0.38	0.30	0.19	0.19	7/16	0.79
HAFM-4-4N	1/4	1/4	1.65	0.56	0.30	0.19	0.19	9/16	0.79
HAFM-4-6N	1/4	3/8	1.66	0.56	0.30	0.19	0.19	11/16	0.79
HAFM-4-8N	1/4	1/2	1.85	0.75	0.30	0.19	0.47	7/8	0.79
HAFM-5-2N	5/16	1/8	1.55	0.38	0.38	0.19	0.19	7/16	0.87
HAFM-5-4N	5/16	1/4	1.73	0.56	0.38	0.19	0.19	9/16	0.87
HAFM-5-6N	5/16	3/8	1.74	0.56	0.38	0.19	0.19	11/16	0.87
HAFM-5-8N	5/16	1/2	1.96	0.75	0.38	0.19	0.47	7/8	0.87
HAFM-6-4N	3/8	1/4	1.73	0.56	0.45	0.30	0.30	9/16	0.87
HAFM-6-6N	3/8	3/8	1.74	0.56	0.45	0.30	0.30	11/16	0.87
HAFM-6-8N	3/8	1/2	1.96	0.75	0.45	0.30	0.30	7/8	0.87
HAFM-8-4N	1/2	1/4	1.80	0.56	0.60	0.38	0.28	11/16	0.94
HAFM-8-6N	1/2	3/8	1.81	0.56	0.60	0.38	0.38	11/16	0.94
HAFM-8-8N	1/2	1/2	2.03	0.75	0.60	0.38	0.38	7/8	0.94
HAFM-10-6N	5/8	3/8	1.88	0.56	0.75	0.50	0.38	1 1/16	0.98
HAFM-10-8N	5/8	1/2	2.07	0.75	0.75	0.47	0.47	1 1/16	0.98
HAFM-10-12N	5/8	3/4	2.07	0.75	0.75	0.50	0.63	1 1/16	0.98
HAFM-12-8N	3/4	1/2	2.14	0.75	0.90	0.63	0.47	1 1/16	1.05
HAFM-12-12N	3/4	3/4	2.14	0.75	0.90	0.63	0.63	1 1/16	1.05
HAFM-12-16N	3/4	1	2.13	0.94	0.90	0.63	0.88	1 3/8	1.05
HAFM-16-12N	1	3/4	2.38	0.75	1.20	0.88	0.63	1 3/8	1.19
HAFM-16-16N	1	1	2.57	0.94	1.20	0.88	0.88	1 3/8	1.19
Part No.	Hose ID	Male ISO 7-1	A	B	D	E	E1	F	L
HAFM-2-2R	1/8	1/8	1.28	0.38	0.15	0.08	0.19	7/16	0.40
HAFM-4-2R	1/4	1/8	1.47	0.38	0.30	0.19	0.19	7/16	0.79
HAFM-4-4R	1/4	1/4	1.65	0.56	0.30	0.19	0.19	9/16	0.79
HAFM-4-6R	1/4	3/8	1.66	0.56	0.30	0.19	0.19	11/16	0.79
HAFM-6-4R	3/8	1/4	1.73	0.56	0.45	0.30	0.30	9/16	0.87
HAFM-6-6R	3/8	3/8	1.74	0.56	0.45	0.30	0.30	11/16	0.87
HAFM-6-8R	3/8	1/2	1.96	0.75	0.45	0.30	0.30	7/8	0.87
HAFM-8-8R	1/2	1/2	2.03	0.75	0.60	0.38	0.47	7/8	0.94

# Female Adapter

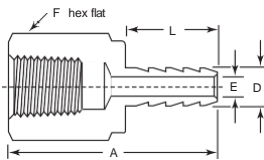

Part No.	End Connections		Dimensions, in.				
	Hose ID	NPT Size	A	D	E	F	L
HAFF-2-2N	1/8	1/8	1.11	0.15	0.08	9/16	0.40
HAFF-2-4N	1/8	1/4	1.26	0.15	0.08	3/4	0.40
HAFF-3-2N	3/16	1/8	1.29	0.23	0.12	9/16	0.59
HAFF-3-4N	3/16	1/4	1.44	0.23	0.12	3/4	0.59
HAFF-4-2N	1/4	1/8	1.47	0.30	0.19	9/16	0.79
HAFF-4-4N	1/4	1/4	1.64	0.30	0.19	3/4	0.79
HAFF-4-6N	1/4	3/8	1.71	0.30	0.19	7/8	0.79
HAFF-5-4N	5/16	1/4	1.73	0.38	0.19	3/4	0.87
HAFF-5-6N	5/16	3/8	1.82	0.38	0.19	7/8	0.87
HAFF-6-4N	3/8	1/4	1.69	0.45	0.30	3/4	0.87
HAFF-6-6N	3/8	3/8	1.78	0.45	0.30	7/8	0.87
HAFF-6-8N	3/8	1/2	2.03	0.45	0.30	1 1/16	0.87
HAFF-8-8N	1/2	1/2	2.13	0.60	0.38	1 1/16	0.94

# Tube Adapter

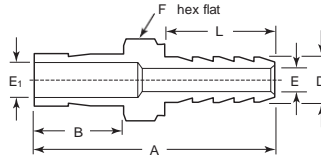

Part No.	End Connections		Dimensions, in.							
	Hose ID	Tube Size	A	B	D	E	E1	F	L	
HAFT- 2-2T	1/8	1/8	1.36	0.54	0.15	0.08	0.09	5/16	0.40	
HAFT- 2-4T	1/8	1/4	1.46	0.64	0.15	0.08	0.19	3/8	0.40	
HAFT-4-4T	1/4	1/4	1.85	0.64	0.30	0.19	0.19	7/16	0.79	
HAFT-4-6T	1/4	3/8	1.91	0.70	0.30	0.19	0.28	7/16	0.79	
HAFT- 4-6MT	1/4	6mm	1.88	0.64	0.30	0.19	0.18	7/16	0.79	
HAFT- 5-4T	5/16	1/4	1.93	0.64	0.37	0.19	0.19	7/16	0.87	
HAFT-6-4T	3/8	1/4	1.93	0.64	0.45	0.30	0.17	9/16	0.87	
HAFT- 6-6T	3/8	3/8	1.99	0.70	0.45	0.30	0.28	9/16	0.87	
HAFT- 6-8T	3/8	1/2	2.25	0.96	0.45	0.30	0.39	5/8	0.87	
HAFT- 8-6T	1/2	3/8	2.06	0.70	0.60	0.38	0.28	11/16	0.94	
HAFT-8-8T	1/2	1/2	2.32	0.96	0.60	0.38	0.39	11/16	0.94	
HAFT-12-12T	3/4	3/4	2.49	1.02	0.90	0.63	0.59	1 3/16	1.05	
HAFT-16-16T	1	1	3.02	1.30	1.20	0.88	0.80	1 3/8	1.19	

# Tube Fitting Adapter

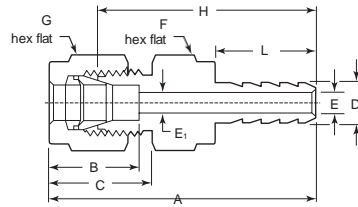

Part No.	End Connections		Dimensions, in.									
	Hose ID	Tube OD	A	B	D	E	E1	F	G	H	L	
HAFTF- 2-2	1/8	1/8	1.46	0.60	0.15	0.08	0.08	7/16	7/16	1.17	0.40	
HAFTF-4-2	1/4	1/8	1.85	0.70	0.30	0.09	0.19	7/16	7/16	1.56	0.79	
HAFTF-4-4	1/4	1/4	1.94	0.70	0.30	0.19	0.19	9/16	9/16	1.63	0.79	
HAFTF- 6-4	3/8	1/4	2.01	0.76	0.45	0.19	0.30	9/16	9/16	1.70	0.87	
HAFTF- 6-6	3/8	3/8	2.06	0.76	0.45	0.30	0.30	3/4	11/16	1.77	0.87	
HAFTF- 8-8	1/2	1/2	2.24	0.86	0.60	0.38	0.41	7/8	7/8	1.84	0.94	