

QUICK CONNECTOR FITTINGS

WVWF

**Western Valve
& Fitting**

**(925-443-8500)
4355 Technology Drive
Livermore, CA 94551**



Table of Contents

Single/Double Valve Couples	Page 2
Ordering Info and Dimension Stems	Page 3
Stem-Bulkheads	Page 4
Bodies	Page 4
Bodies- Bulkheads	Page 5
Color Code Keyed Quick Connectors	Page 6
Series Miniature Quick Connectors	Page 7
Full Flow Quick Connectors	Page 9-17

HQ, HQM, HF, HQPM

Series

No tools required to couple and uncouple.

- Bi-directional flow design.
- Versatile options of both-end shutoff (DV), single-end shutoff (SV), and both end open (HF Series).

- HQ Series Quick Connector
- HQM Series Miniature Quick Connector
- HDF Series Full Flow Quick Connector
- HQPM PTFE Sealed Quick Connect

HQ Series Quick Connectors



Features

- Bi-directional flow design.
- Simple to operate.
- SS316 construction with standard FKM O-ring.
- Brass construction with standard NBR O-ring.
- No tools required to couple and uncouple.
- Compact and light-weight design.

Operation

- Coupling
 1. Align the stem with the body in the identical Series.
 2. Push the stem into the body until it clicks.
- Uncoupling
 1. Pull the body sleeve toward stem.
 2. Remove stem from body.
- Do not couple or uncouple at pressures exceeding 250 psig (17.2 bar).

SV: Single valve coupled

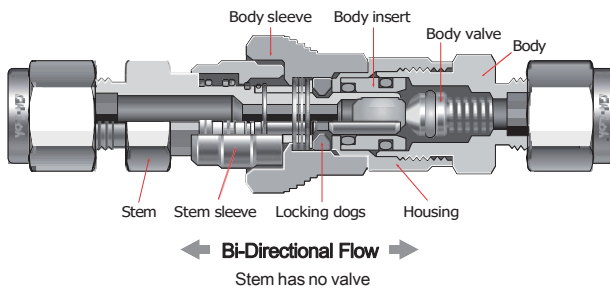

DV: Double valve coupled

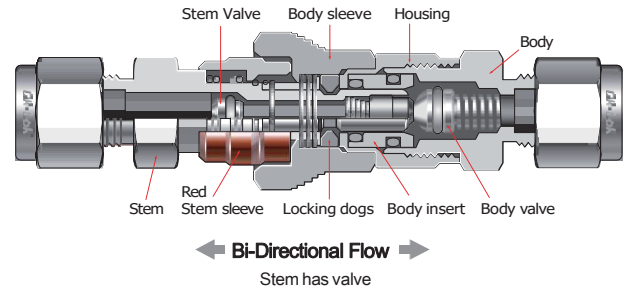

Materials of Construction

Component	Material	
	SS316	Brass
Body, Housing Body valve Body insert	SS316/ ASTM A276	JIS H3250 C3604
Body sleeve Locking dogs	Xylan™-coated SS316 powered	
Stem Stem sleeve Stem valve	SS316 / ASTM A276	JIS H3250 C3604
O-rings	FKM	NBR
Springs	SS302/ASTM A313	
Lubricants	Silicon and TFE based	

Wetted parts indicated in blue.

Pressure-Temperature Ratings

HQ Stem and Body	SS FKM O-rings			Brass NBR O-rings		
	HQA	HQB	HQC	HQA	HQB	HQC
	psi (bar) @ °F (°C)					
Coupled	3000 (206) @ 70 (21)	1500 (103) @ 70 (21)	750 (51.6) @ 70 (21)	2000 (137) @ 70 (21)	1000 (68.9) @ 70 (21)	500 (34.4) @ 70 (21)
	250 (17.2) @ 400 (204)			250 (17.2) @ 250 (121)		
Uncoupled	250 (17.2) @ 70 (21)					
When coupling and uncoupling	250 (17.2) @ 70 (21)					

Spillage and Air Inclusion

- Spillage is the volume of system fluid that escapes while a quick connector is uncoupled.
- Air inclusion is the volume of air trapped that comes in while a quick connector is coupled.

DQ Series	Spillage	Air Inclusion
HQA	0.3	0.3
HQB	1.0	1.0
HQC	3.0	3.0

Ordering Information and Dimensions Stems

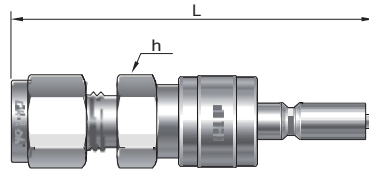

DV : Stem has a valve

SV : Stem has no valve

Series	End Connection	Basic Ordering Number		Cv			L mm (in.)		h Hex in.
		SV	DV	SV	DV	Full Flow	SV	DV	
HQA	1/8 in. Compression	HQSA-C-1/8-	HQVSA-C-1/8-	0.08	0.08	0.08	58.9 (2.32)	70.4 (2.77)	5/8
	1/4 in. Compression	HQSA-C-1/4-	HQVSA-C-1/4-	0.3	0.2	0.4	59.9 (2.36)	61.5 (2.42)	5/8
	6 mm Compression	HQSA-C-6M-	HQVSA-C-6M-	0.3	0.2	0.4	59.9 (2.36)	61.5 (2.42)	5/8
	1/8 in. Male NPT	HQSA-M-1/8-	HQVSA-M-1/8-	0.3	0.2	0.4	52.6 (2.07)	54.1 (2.13)	5/8
	1/4 in. Male NPT	HQSA-M-1/4-	HQVSA-M-1/4-	0.3	0.2	0.4	56.4 (2.22)	57.9 (2.28)	5/8
	1/8 in. Female NPT	HQSA-F-1/8-	HQVSA-F-1/8-	0.3	0.2	0.4	51.1 (2.01)	52.6 (2.07)	5/8
	1/4 in. Female NPT	HQSA-F-1/4-	HQVSA-F-1/4-	0.3	0.2	0.4	57.4 (2.26)	58.9 (2.32)	3/4
HQB	3/8 in. Compression	HQSB-C-3/8-	HQVSB-C-3/8-	1.0	0.5	1.5	64.0 (2.52)	67.1 (2.64)	3/4
	10 mm Compression	HQSB-C-10M-	HQVSB-C-10M-	1.0	0.5	1.5	67.3 (2.65)	70.4 (2.77)	3/4
	1/4 in. Male NPT	HQSB-M-1/4-	HQVSB-M-1/4-	0.9	0.5	1.5	58.9 (2.32)	61.9 (2.44)	3/4
	3/8 in. Male NPT	HQSB-M-3/8-	HQVSB-M-3/8-	0.8	0.5	1.6	59.7 (2.35)	62.7 (2.47)	3/4
	1/4 in. Female NPT	HQSB-F-1/4-	HQVSB-F-1/4-	0.9	0.5	1.5	59.7 (2.35)	62.7 (2.47)	3/4
	3/8 in. Female NPT	HQSB-F-3/8-	HQVSB-F-3/8-	0.8	0.5	1.6	59.7 (2.35)	62.7 (2.47)	7/8
HQC	1/2 in. Compression	HQSC-C-1/2-	HQVSC-C-1/2-	2.4	1.5	3.3	75.2 (2.96)	80.3 (3.16)	15/16
	12 mm Compression	HQSC-C-12M-	HQVSC-C-12M-	2.4	1.5	3.3	75.2 (2.96)	80.3 (3.16)	15/16
	1/2 in. Male NPT	HQSC-M-1/2-	HQVSC-M-1/2-	2.0	1.3	3.1	72.1 (2.84)	77.2 (3.04)	15/16
	1/2 in Female NPT	HQSC-F-1/2-	HQVSC-F-1/2-	2.0	1.3	3.1	71.6 (2.82)	76.7 (3.02)	1 1/16

Stems-Bulkhead

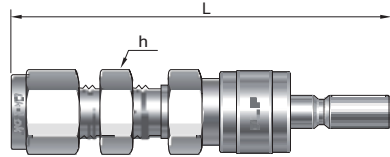

DV : Stem has a valve

SV : Stem has no valve

Series	End Connection	Basic Ordering Number		Panel Thickness Max. mm (in.)	Panel Hole Dia. Min. mm (in.)	L mm (in.)		h Hex. in.
		SV	DV			SV	DV	
HQA	1/4 in. Compression	HQSA-BH-C-1/4-	HQVSA-BH-C-1/4-	6.4 (0.25)	11.9 (15/32)	69.6 (2.74)	71.1 (2.80)	5/8
	6 mm Compression	HQSA-BH-C-6M-	HQVSA-BH-C-6M-	6.4 (0.25)	11.5 (29/64)	69.6 (2.74)	71.1 (2.80)	16 mm
HQB	3/8 in. Compression	HQSB-BH-C-3/8-	HQVSB-BH-C-3/8-	6.9 (0.27)	15.1 (19/32)	74.2 (2.92)	76.0 (3.07)	3/4
	10 mm Compression	HQSB-BH-C-10M-	HQVSB-BH-C-10M-	6.9 (0.27)	16.7 (21/32)	77.7 (3.06)	78.7 (3.10)	22 mm
HQC	1/2 in. Compression	HQSC-BH-C-1/2-	HQVSC-BH-C-1/2-	6.6 (0.26)	19.8 (25/32)	87.1 (3.43)	92.2 (3/63)	15/16
	12 mm Compression	HQSC-BH-C-12M-	HQVSC-BH-C-12M-	6.6 (0.26)	19.4 (49/64)	87.1 (3.43)	92.2 (3.63)	24 mm

Insertion depth and Overall length To have an overall length in coupled position, subtract the insertion depth from the combination length of the stem and the body.

Insertion Depth

HQ Series	Depth mm (in.)	
	SV	DV
HQA	27.7 (1.09)	29.2 (29.2)
HQB	30.0 (1.18)	33.0 (1.30)
HQC	37.6 (1.18)	42.7 (1.68)

Bodies

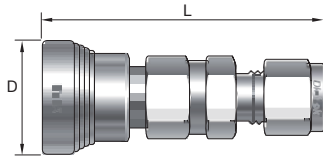

Series	End Connection	Basic Ordering Number	L mm (in.)	D mm (in.)
HQA	1/8 in. Compression	HQBA-C-1/8-	57.4 (2.26)	23.1 (0.91)
	1/4 in. Compression	HQBA-C-1/4-	56.4 (2.30)	23.1 (0.91)
	6 mm Compression	HQBA-C-6M-	58.4 (2.30)	23.1 (0.91)
	1/8 in. Male NPT	HQBA-M-1/8-	51.1 (2/01)	23.1 (0.91)
	1/4 in. Male NPT	HQBA-M-1/4-	54.9 (2.16)	23.1 (0.91)
	1/4 in. Male ISO	HQBA-M-1/4R-	54.9 (2.16)	23.1 (0.91)
	1/8 in. Female NPT	HQBA-F-1/8-	54.9 (2.16)	23.1 (0.91)
	1/4 in. Female NPT	HQBA-F-1/8-	61.5 (2.42)	23.1 (0.91)
	1/4 in. Female ISO	HQBA-F-1/4R-	61.5 (2.42)	23.1 (0.91)
HQB	3/8 in. Compression	HQBB-C-3/8-	65.5 (2.58)	26.2 (1.03)
	10 mm Compression	HQBB-C-10M-	68.1 (2.68)	26.2 (1.03)
	1/4 in. Male NPT	HQBB-M-1/8-	60.5 (2.38)	26.2 (1.03)
	3/8 in. Male NPT	HQBB-M-3/8-	60.5 (2.38)	26.2 (1.03)
	3/8 in. Male ISO	HQBB-M-3/8R-	60.5 (2.38)	26.2 (1.03)
	1/4 in. Female NPT	HQBB-F-1/8-	64.5 (2.54)	26.2 (1.03)
	3/8 in. Female NPT	HQBB-F-3/8-	65.3 (2.57)	26.2 (1.03)
	3/8 in. Female ISO	HQBB-F-3/8R-	65.3 (2.57)	26.2 (1.03)
HQC	1/2 in Compression	HQBC-C-1/2-	78.5 (3.09)	30.7 (1.21)
	12 mm Compression	HQBC-C-12M-	78.5 (3.09)	30.7 (1.21)
	1/2 in. Male NPT	HQBC-M-1/2-	75.4 (2.97)	30.7 (1.21)
	1/2 in. Male ISO	HQBC-M-1/2R-	75.4(2.97)	30.7 (1.21)
	1/2 in. Female NPT	HQBC-F-1/2-	81.8 (3.22)	30.7 (1.21)
	1/2 in. Female ISO	HQBC-F-1/2R-	81.8 (3.22)	30.7 (1.21)

Bodies-Bulkhead

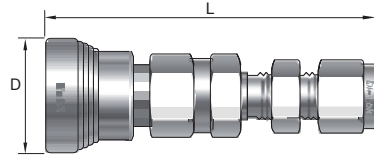

Series	End Connection	Basic Ordering Number	Panel Thickness Max.	Panel Hole Dia. Min.	L	D
			mm (in.)			
HQA	1/4 in. Compression	HQBA-BH- C-1/4-	6.4 (0.25)	11.9 (15/32)	67.8 (2.67)	23.1 (0.91)
	6 mm Compression	HQBA-BH- C-6M-	6.4 (0.25)	11.9 (15/32)	67.8 (2.67)	23.1 (0.91)
HQB	3/8 in. Compression	HQBB-BH- C-3/8-	6.9 (0.27)	15.1 (19/32)	75.7 (2.98)	26.2 (1.03)
	10mm Compression	HQBB-BH-C-10M-	6.9 (0.27)	16.7 (21/32)	75.9 (2.99)	26.2 (1.03)
HQC	1/2 in. Compression	HQBC-BH-C-1/2-	6.6 (0.26)	19.8 (25/32)	90.4 (3.56)	30.7 (1.21)
	12 mm Compression	HQBC-BH-C-12M-	6.6 (0.26)	19.4 (49/64)	90.4 (3.56)	30.7 (1.21)

How to Order

Add "SA" for SS316 or "BA" for Brass as a suffix to the Basic Ordering Number.

Examples: HQSA-C-1/4-SA, HQBA-C-1/4-BA.

O-ring Designators

<p>Nil : Standard FKM for SS316 quick connector Nil : Standard NBR for Brass quick connector FKM : VT NBR : BN FFKM : KZ</p>	<p>How to Order an Optional O-ring Connector Insert O-ring designator to the basic ordering number. Examples: HQVSA-C-1/8-KZ-SA, HQVSA-C-1/8-EP-BA</p>
--	---

How to Order a Full Flow DQ Series Connector

A full flow HQ series consists of a SV stem and a full flow body.

To order a full flow body, select an applicable Basic Ordering Number, add "FF" and a material designator.

Examples: HQBA-C-1/4-FF-SA, HQBB-C-3/8-FF-SA.

Options

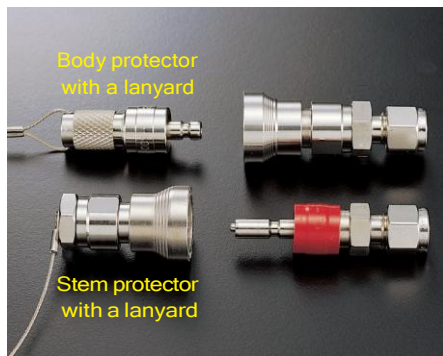

HQ Protectors

Body and Stem Protector are available to protect body and stem from damage and contamination while they are uncoupled.

Field Assembly Protector Ordering Number

Stem Protector	Body Protector
HQSA-CP-	HQBA-PG-
HQSB-CP-	HQBB-PG-
HQSC-CP-	HQBC-PG-

To complete ordering number, add a material designator "SA" for SS316, "BA" for Brass as a suffix to the protector ordering number.

Examples: HQSA-CP-SA, HQBA-PG-BA

Note : Stem Protector is applicable to both SV stem and DV stem.

Pressure Retaining Protectors

DQ Protectors are not pressure retaining devices.

To order the pressure retaining protector, add "P" as a suffix to the protector ordering number.

Examples: HQSA-CP-P, HQBA-PG-P.

How to order FACTORY ASSEMBLED PROTECTOR on to DQ stem and body.

Select an applicable STEM or BODY ordering number, and insert "CP" or "PG" in the ordering

Materials of Construction

Protector: Stainless steel or Brass

Lanyard: Stainless steel number.

Examples: HQVSC-C-12M-CP-SA, HQBC-C-12M-PG-SA.

HQ color coded “Keyed” quick connectors



Features

- HQ Keyed quick connectors prevent intermixing of different keys mechanically as well as allow visual identification by color coding.
- Eight (8) different keys on each HQ series are available with its own Key number.
- HQ keys are useful to control multi-fluid or multi-pressure systems.

Operation

- Select stem and body keyed in the same HQ series.
- Coupling: Align stem with body. Push stem into body until it clicks.
- Uncoupling: Pull body sleeve toward stem. Remove stem.

HQ Key Ordering Numbers and Sleeve Outside Diameter

Key Number	Key Color	HQA				HQB				HQC			
		Body Sleeve		Stem Sleeve		Body Sleeve		Stem Sleeve		Body Sleeve		Stem Sleeve	
		mm	inch	mm	inch	mm	inch	mm	inch	mm	inch	mm	inch
K1	Black	24.5	0.96	20.9	0.82	28.7	1.13	25.1	0.99	32.0	1.26	27.9	1.10
K2	Orange	25.0	0.99	21.6	0.85	29.5	1.16	25.8	1.02	32.8	1.29	28.9	1.14
K3	Green	26.0	1.02	22.4	0.88	30.2	1.19	26.6	1.05	33.6	1.32	29.7	1.17
K4	Yellow	26.8	1.05	23.2	0.91	31.0	1.22	27.4	1.08	34.3	1.35	30.4	1.20
K5	Blue	27.5	1.08	23.9	0.94	31.5	1.24	28.1	1.11	35.1	1.38	31.2	1.23
K6	White	28.3	1.11	24.7	0.97	32.5	1.28	28.9	1.14	35.8	1.41	32.0	1.26
K7	Purple	29.1	1.14	25.4	1.00	33.3	1.31	29.7	1.17	36.6	1.44	32.7	1.29
K8	Brown	29.8	1.17	26.2	1.03	34.0	1.34	30.4	1.20	37.4	1.47	33.5	1.32
Standard HQ Body Sleeve Dia.		23.1	0.91			26.2	1.03			30.7	1.21		

HQM Series Miniature Quick Connectors

Features

- Bi-directional flow design.
- Miniature design for max. 4000 psi working pressure.
- Stainless steel and brass construction.
- Operation: To couple, to uncouple, pull body sleeve toward body.

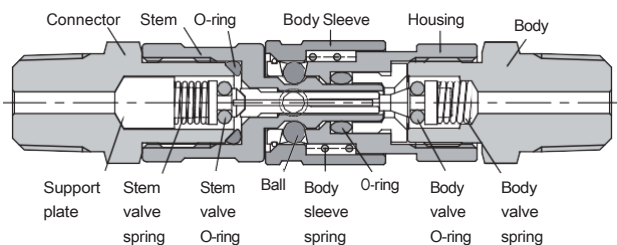

← Bi-Directional Flow →

Materials of Construction

Component	Material	
	Stainless	Brass
Body, Housing, Stem, Connector, Body sleeve	SS316/ ASTMA276	JIS H3250 C3604
Support plate, Left & Right fin	Stainless Steel	
Body valve, Stem valve	SS316/ ASTM A276	
Springs	SS302/ASTM A313	
O-rings	FKM	NBR
Locking ball	SS316	
Lubricants	Silicon and TFE based	

Wetted parts indicated in blue.

Ordering Information and Dimensions

Stems

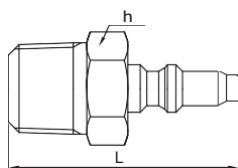

SV : Stem has no valve

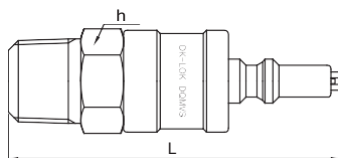

DV : Stem has a valve



End Connection	Basic Ordering Number		Cv			L mm (in.)		h Hex. in.
	SV	DV	SV	DV	Full Flow	SV	DV	
1/16 in. Compression	HQMS-C-1/16-	HQMVS-C-1/16-	0.06	0.05	0.06	30.0 (1.18)	44.7 (1.76)	7/16
1/16 in. Male NPT	HQMS-M-1/16-	HQMVS-M-1/16-	0.06	0.05	0.06	26.2 (1.03)	40.9 (1.61)	7/16
1/16 in. Female NPT	HQMS-F-1/16-	HQMVS-F-1/16-	0.06	0.05	0.06	26.2 (1.03)	40.9 (1.61)	7/16
1/8 in. Compression	HQMS-C-1/8-	HQMVS-C-1/8-	0.06	0.05	0.06	32.8 (1.29)	47.5 (1.87)	7/16
1/8 in. Male NPT	HQMS-M-1/8-	HQMVS-M-1/8-	0.06	0.05	0.06	26.2 (1.03)	40.9 (1.61)	7/16
1/8 in. Female NPT	HQMS-F-1/8-	HQMVS-F-1/8-	0.06	0.05	0.06	26.2 (1.03)	40.9 (1.61)	9/16

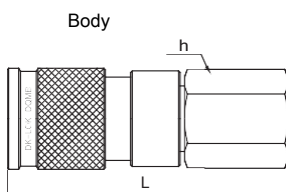

Basic Ordering Number	End Connection	L mm (in.)	h Hex. in.
HQMB-C-1/16-	1/16 in. Compression	38.1 (1.50)	7/16
HQMB-C-1/8-	1/8 in. Compression	43.2 (1.70)	7/16
HQMB-M-1/16-	1/16 in. Male NPT	36.1 (1.42)	7/16
HQMB-M-1/8-	1/8 in. Male NPT	36.6 (1.44)	7/16
HQMB-F-1/16-	1/16 in. Female NPT	36.3 (1.43)	7/16
HQMB-F-1/8-	1/8 in. Female NPT	41.1 (1.62)	9/16
HQMB-BH*-C-1/8-	1/8 in. Compression	53.1(2.09)	7/16

* BH : Bulkhead

How to Order a Full Flow HQM Quick Connector

A full flow HQM series consists of a SV stem a full flow body.

To order a full flow body, select an applicable basic ordering number, add "FF" and a material designator.

i.e., HQMB-C-1/8-FF-SA

Pressure- Temperature Ratings

HQM Stem and Body	SS FKM O-rings	Brass NBR O-rings
	Pressure Rating psi (bar) @ °F (°C)	
Coupled	4000 (275) @ 70 (21)	2000 (137) @ 70 (21)
	100 (6.8) @ 400 (204)	100 (6.8) @ 250 (121)
Uncoupled	100 (6.8) @ 70 (21)	
When coupling & uncoupling	100 (6.8) @ 70 (21)	

HF Series Full Flow Quick Connectors

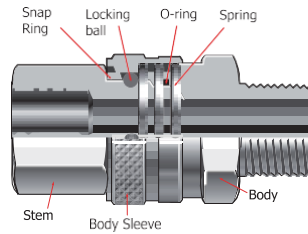

Features

- Bi-directional flow design.
- Applicable to maximum flow.
- Lowest pressure drop.
- No tools required to connect & disconnect

Materials of Construction

Component	Materials	
	SS316	Brass
Body, Stem	SS316/ASTM A276	JIS H3250 C3604
Sleeve		
Snap Ring	SS316	SS316
Spring, Locking Ball	Stainless Steel	
O-ring	FKM	NBR
Lubricant	Silicon-based and PTFE-based lubricants	

Wetted parts and lubrication are indicated in blue.

Max. Pressure @ 70°F (21°C)

HF Series	SS316	Brass
	psig (bar)	psig (bar)
HFA	6000 (413)	4000 (275)
HFB		3000 (206)
HFC	4000 (275)	4000 (275)
HFD		

Cleaning and Packaging

Every connector is cleaned, and packed in a plastic sealing bag to keep them from dust, and then boxed for protection from damage during transportation and storage.

Max. Temperature Rating

HF Materials	O-ring Material	Max. Temp. Rating	Pressure Rating @ Max. Temp.
SS316	FKM	400 F (204°C)	100 psig (6.8 bar)
Brass	NBR	250 F (121°C)	100 psig (6.8 bar)

Operation

Coupling

1. Align stem with body.
2. Pull the body sleeve back.
3. Insert stem into body until it bottoms.
4. Return body sleeve to its original position.

Uncoupling

1. Pull the body sleeve back completely.
2. Remove stem from body.

Caution: Do not uncouple under pressure.

Note :

Couple the identical Series of stem and body.

Example: Any HFBA series body will fit any HFSA series stem.

Ordering Information and Dimensions

Stems

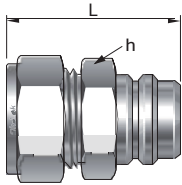

Basic Ordering Number	End Connection	Cv	Orifice Min.	L	h	
			mm (in.)		in.	
HFSA-	C-1/4-	1/4 in. Compression	2.2	4.8 (0.19)	45.0 (1.77)	9/16
	C-3/8-	3/8 in. Compression	2.8	6.1 (0.24)	45.0 (1.77)	11/16
	C-6M-	6 mm Compression	2.2	4.8 (0.19)	45.0 (1.77)	9/16
	M-1/4-	1/4 in. Male NPT	1.7	6.1 (0.24)	40.4 (1.59)	9/16
	M-3/8-	3/8 in. Male NPT	1.7	6.1 (0.24)	40.4 (1.59)	11/16
	F-1/4-	1/4 in. Female NPT	1.7	6.1 (0.24)	40.6 (1.60)	3/4
HFSA-	F-3/8-	3/8 in. Female NPT	1.7	6.1 (0.24)	42.4 (1.67)	7/8
	C-3/8-	3/8 in. Compression	2.9	7.1 (0.28)	47.8 (1.88)	7/8
	C-1/2-	1/2 in. Compression	13.0	10.4 (0.41)	50.5 (1.99)	7/8
	M-3/8-	3/8 in. Male NPT	7.1	10.4 (0.41)	40.4 (1.59)	7/8
	M-8N-	1/2 in. Male NPT	11.5	12.7 (0.50)	46.7 (1.84)	7/8
	F-3/8-	3/8 in. Female NPT	7.1	11.9 (0.47)	40.4 (1.59)	1 1/16
HFSC-	F-1/2-	1/2 in. Female NPT	11.5	12.7 (0.50)	46.2 (1.82)	1 1/16
	C-3/4-	3/4 in. Compression	26.0	15.7 (0.62)	54.6 (2.15)	1 1/16
	M-3/4-	3/4 in. Male NPT	23.6	18.3 (0.72)	51.6 (2.03)	1 1/16
HFSD-	F-3/4-	3/4 in. Female NPT	23.6	18.3 (0.72)	52.8 (2.08)	1 5/16
	C-1.0-	1 in. Compression	45.0	22.4 (0.88)	62.2 (2.45)	1 3/8
	M-1.0-	1 in. Male NPT	39.0	22.4 (0.88)	59.7 (2.35)	1 3/8
	F-1.0-	1 in. Female NPT	39.0	22.4 (0.88)	63.2 (2.49)	1 5/8

Bodies

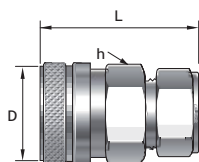

Basic Ordering Number	End Connection	Orifice Min.	L	D	h in.	
		mm (in.)				
HFBA-	C-1/4-	1/4 in. Compression	4.8 (0.19)	45.7 (1.80)	22.1 (0.87)	1 1/16
	C-3/8-	3/8 in. Compression	7.1 (0.28)	46.0 (1.81)	22.1 (0.87)	1 1/16
	C-6M-	6 mm Compression	4.8 (0.19)	45.7 (1.80)	22.1 (0.87)	11/16
	M-1/4-	1/4 in. Male NPT	6.4 (0.25)	39.9 (1.57)	22.1 (0.87)	11/16
	M-3/8-	3/8 in. Male NPT	9.4 (0.37)	39.9 (1.57)	22.1 (0.87)	11/16
	F-1/4-	1/4 in. Female NPT	9.7 (0.38)	38.1 (1.50)	22.1 (0.87)	3/4
	F-3/8-	3/8 in. Female NPT	9.7 (0.38)	41.4 (1.63)	22.1 (0.87)	7/8
HFBB-	C-3/8-	3/8 in. Compression	7.1 (0.28)	55.1 (2.17)	33.0 (1.30)	1 1/16
	C-1/2-	1/2 in. Compression	11.9 (0.47)	56.6 (2.23)	33.0 (1.30)	1 1/16
	M-3/8-	3/8 in. Male NPT	10.4 (0.41)	46.5 (1.83)	33.0 (1.30)	1 1/16
	M-1/2-	1/2 in. Male NPT	12.7 (0.50)	52.8 (2.08)	33.0 (1.30)	1 1/16
	F-3/8-	3/8 in. Female NPT	15.0 (0.59)	43.9 (1.73)	33.0 (1.30)	1 1/16
	F-1/2-	1/2 in. Female NPT	16.0 (0.63)	43.9 (1.73)	33.0 (1.30)	1 1/16
HFBC-	C-3/4-	3/4 in. Compression	15.7 (0.62)	62.2 (2.45)	42.2 (1.66)	1 1/2
	M-3/4-	3/4 in. Male NPT	18.3 (0.72)	59.2 (2.33)	42.2 (1.66)	1 1/2
	F-3/4-	3/4 in. Female NPT	22.4 (0.88)	48.0 (1.89)	42.2 (1.66)	1 1/2
HFBD-	C-1.0-	1 in. Compression	22.4 (0.88)	69.9 (2.75)	47.8 (1.88)	1 11/16
	M-1.0-	1 in. Male NPT	22.4 (0.88)	67.3 (2.65)	47.8 (1.88)	1 11/16
	F-1.0-	1 in. Female NPT	26.9 (1.06)	53.8 (2.12)	47.8 (1.88)	1 11/16

HF Protectors

Body and Stem Protector are available to protect body and stem from damage and contamination while they are uncoupled.

Field Assembly Protector Ordering Number

Stem Protector	Body Protector
HFSA-CP-	HFBA-PG-
HFSB-CP-	HFBB-PG-
HFSC-CP-	HFBC-PG-
HFSD-CP-	HFBD-PG-

To complete ordering number, add a material designator "SA" for SS316, "BA" for Brass as a suffix to the protector ordering number.

Examples: HFSA-CP-SA, HFBA-PG-BA.

Insertion Depth

Unit: mm (in.)

DF Series	Depth
HFA	19.8 (0.78)
HFBB	20.6 (0.81)
HFC	22.9 (0.90)
HFD	23.9 (0.94)

How to order FACTORY ASSEMBLED PROTECTOR on to HF stem and body.

Select an applicable STEM or BODY ordering number, and insert "CP" or "PG" in the ordering number.

Examples: HFSA-C-1/4-CP-SA, HFBA-C-1/4-PG-SA

Safety Pin Option on HF series

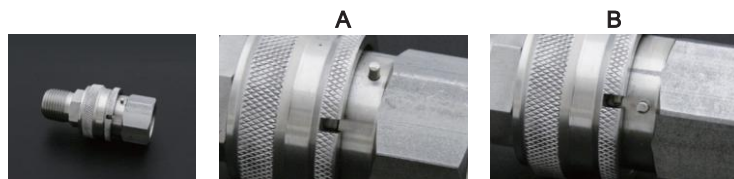

A. A safety pin on body with a holding groove on sleeve prevents accidental uncoupling.

B. To Uncouple, rotate body sleeve for the pin to fit into the groove and pull the body sleeve back.

To order Safety Pin HF body, insert "P" in the ordering number. Example: HFBC-C-3/4-P-SA

All dimensions shown are for reference only and subject to change. Dimensions with Compression Tube Fittings are finger-tight position. We reserve the right to change specification stated in this catalog for our continuing program of product improvement.

HQPM Series PTFE Sealed Quick Connect



Features

- Bi-directional flow design.
- Simple to operate.
- No tools required to couple and uncouple.
- Keyed option is available.
- Max working pressure : 4,500psi.
- Stainless steel and Monel 400 construction.

Operation

- Coupling
 1. Align the stem with the body in the identical Series.
 2. Push the stem into the body until it clicks.
- Uncoupling
 1. Pull the body sleeve toward stem.
 2. Remove stem from body.
- Do not couple or uncouple at pressures exceeding 250 psig (17.2 bar).

Note

Couple the identical Series of stem and body.
Any HQPM8 body will fit any HQPM8D(DV) or HQPM8S(SV) stem.

Materials of Construction

DV : Double valve coupled

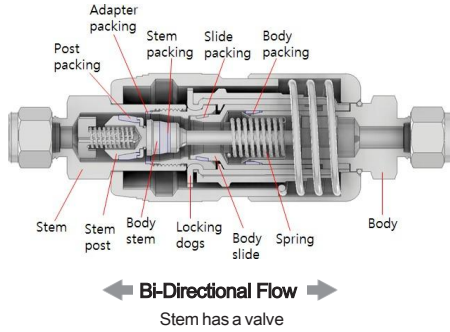

SV : Single valve coupled

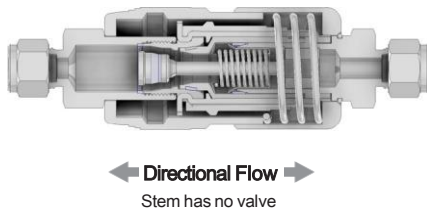

Component	Material	
	SS316	Alloy 400 / Monel
Valve body	SS316 / Xylan Coated	Alloy 400 / Xylan Coated
Stem body, Adapter Post, Post cap Body cap1, Body cap2 Body Insert Slide, Body stem Body stem cap	SS316 / ASTM A276	Alloy 400 / ASTM B164
Stem Spring guide1 Stem Spring guide2	SS316	Alloy 400
Body Locking dogs Body Locking bracket Slide spring guide1 Slide spring guide2	SS304	Alloy 400
Adapter packing Body packing Body backup packing Slide packing	TFM 1600	
Post packing Stem packing	PTFE	
Slide spring Stem spring Body cap spring	SS316 or Alloy X-750	Alloy X-750

Wetted parts indicated in blue

Pressure-Temperature Ratings

HQPM Stem and Body	SS316			Alloy 400
	HQPM2	HQPM4	HQPM8	HQPM2
	psi (bar)@°F (°C)			
Coupled	4500 (310) @ 0 ~ 194 (-17 ~ 90)	3200 (220) @ 0 ~ 194 (-17 ~ 90)	3200 (220) @ 0 ~ 194 (-17 ~ 90)	3200 (220) @ 0 ~ 120 (-17 ~ 48)
Uncoupled	1000 (68.9) @ 0 ~ 194 (-17 ~ 90)			1000 (68.9) @ 0 ~ 120 (-17 ~ 48)
When coupling and uncoupling	250 (17.2) @ 70(20)	100 (6.8) @ 70(20)	50 (3.4) @ 70(20)	250 (17.2) @ 70(20)

Spillage and Air Inclusion (DV Only)

Series	Spillage	Air Inclusion
HQPM2	0.1	0.1
HQPM4	0.2	0.4
HQPM8	1.0	2.0

unit : cm³

Ordering Information and Dimensions

Bodies

Compression Tube Fitting

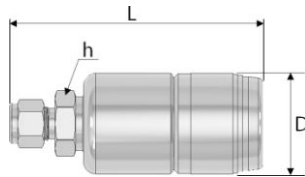

Series	End Connection	Basic Ordering Number	D mm (in.)	L mm (in.)	h Hex. In
Compression Tube Fitting					
HQPM2	1/4 in. Compression	HQPM2-C-1/4	28.4 (1.12)	80.3 (3.16)	5/8
	3/8 in. Compression	HQPM2-C-3/8	28.4 (1.12)	82.6 (3.25)	11/16
	6 mm Compression	HQPM2-C-6M	28.4 (1.12)	80.3 (3.16)	15mm
	8 mm Compression	HQPM2-C-8M	28.4 (1.12)	80.3 (3.16)	15mm
HQPM4	1/4 in. Compression	HQPM4-C-1/4	44.0 (1.73)	104.0 (4.08)	15/16
	3/8 in. Compression	HQPM4-C-3/8	44.0 (1.73)	104.0 (4.08)	15/16
	6 mm Compression	HQPM4-C-6M	44.0 (1.73)	104.0 (4.08)	24mm
	10 mm Compression	HQPM4-C-10M	44.0 (1.73)	104.0 (4.08)	24mm
HQPM8	1/2 in. Compression	HQPM8-C-1/2	50.8 (4.30)	109.0 (4.30)	1-1/4
	3/4 in. Compression	HQPM8-C-3/4	50.8 (4.30)	109.0 (4.30)	1-1/4
	1 in. Compression	HQPM8-C-1.0	50.8 (4.30)	116.0 (4.58)	1-3/8
	12 mm Compression	HQPM8-D12M	50.8 (4.30)	109.0 (4.30)	32mm

Male NPT / BSPT

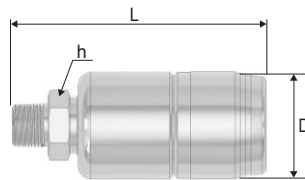

Series	End Connection	Basic Ordering Number	D mm (in.)	L mm (in.)	h Hex. In
Male NPT					
HQPM2	1/4 in. Male NPT	HQPM2-M-1/4	28.4 (1.12)	76.7 (3.02)	5/8
	3/8 in. Male NPT	HQPM2-M-3/8	28.4 (1.12)	78.0 (3.07)	3/4
HQPM4	1/4 in. Male NPT	HQPM4-M-1/4	44.0 (1.73)	98.9 (3.89)	15/16
	3/8 in. Male NPT	HQPM4-M-3/8	44.0 (1.73)	98.9 (3.89)	15/16
HQPM8	1/2 in. Male NPT	HQPM8-M-1/2	50.8 (4.30)	109.0 (4.30)	1-1/4
	3/4 in. Male NPT	HQPM8-M-3/4	50.8 (4.30)	109.0 (4.30)	1-1/4
	1 in. Male NPT	HQPM8-M-1.0	50.8 (4.30)	116.0 (4.58)	1-3/8
ISO Tapered Male BSPT					
HQPM2	1/4 in. Male PT	HQPM2-IT-1/4	28.4 (1.12)	76.7 (3.02)	5/8
	3/8 in. Male PT	HQPM2-IT-3/8	28.4 (1.12)	78.0 (3.07)	3/4
HQPM4	1/4 in. Male PT	HQPM4-IT-1/4	44.0 (1.73)	98.9 (3.89)	15/16
	3/8 in. Male PT	HQPM4-IT-3/8	44.0 (1.73)	98.9 (3.89)	15/16
HQPM8	1/2 in. Male PT	HQPM8-IT-1/2	50.8 (4.30)	109.0 (4.30)	1-1/4
	3/4 in. Male PT	HQPM8-IT-3/4	50.8 (4.30)	109.0 (4.30)	1-1/4
	1 in. Male PT	HQPM8-IT-1.0	50.8 (4.30)	116.0 (4.58)	1-3/8

Male BSPP

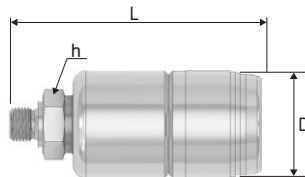

Series	End Connection	Basic Ordering Number	D mm (in.)	L mm (in.)	h Hex. In
ISO Parallel Male BSPP					
HQPM2	1/4 in. Male PF	HQPM2-IP-1/4	28.4 (1.12)	76.7 (3.02)	3/4
HQPM4	1/4 in. Male PF	HQPM4-IP-1/4	44.0 (1.73)	98.9 (3.89)	15/16
HQPM8	1/2 in. Male PF	HQPM8-IP-1/2	50.8 (4.30)	109.0 (4.30)	1-1/4

Male JIC 37°

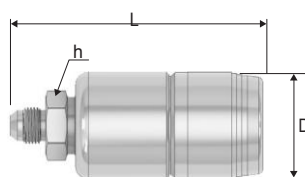

Series	End Connection	Basic Ordering Number	D mm (in.)	L mm (in.)	h Hex. In
JIC 37° Flare					
HQPM4	1/4 in. AN Flare	HQPM4-AN-1/4	44.0 (1.73)	98.9 (3.89)	15/16
HQPM8	1/2 in. AN Flare	HQPM8-AN-1/2	50.8 (4.30)	109.0 (4.30)	1-1/4

Ordering Information and Dimensions Bodies

Bodies

Female NPT / BSPT/ BSPP

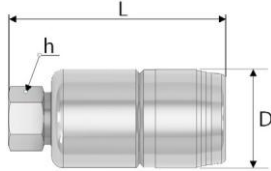

Series	End Connection	Basic Ordering Number	D mm (in.)	L mm (in.)	h Hex. In
Female NPT					
HQPM2	1/8 in. Female NPT	HQPM2-F-1/8	28.4 (1.12)	66.0 (2.60)	5/8
	1/4 in. Female NPT	HQPM2-F-1/4	28.4 (1.12)	75.9 (2.99)	3/4
	3/8 in. Female NPT	HQPM2-F-3/8	28.4 (1.12)	77.2 (3.04)	3/4
HQPM4	1/4 in. Female NPT	HQPM4-F-1/4	44.0 (1.73)	85.1 (3.35)	15/16
	3/8 in. Female NPT	HQPM4-F-3/8	44.0 (1.73)	85.1 (3.35)	15/16
HQPM8	1/2 in. Female NPT	HQPM8-F-1/2	50.8 (4.30)	89.7 (3.53)	1-1/4
	3/4 in. Female NPT	HQPM8-F-3/4	50.8 (4.30)	102.0 (4.02)	1-5/16
	1 in. Female NPT	HQPM8-F-1.0	50.8 (4.30)	112.0 (4.40)	1-5/8
ISO Tapered Female BSPT					
HQPM2	1/4 in. Female PT	HQPM2-FIT-1/4	28.4 (1.12)	75.9 (2.99)	3/4
HQPM4	1/4 in. Female PT	HQPM4-FIT-1/4	44.0 (1.73)	85.1 (3.35)	15/16
HQPM8	1/2 in. Female PT	HQPM8-FIT-1/2	50.8 (4.30)	89.7 (3.53)	1-1/4
ISO Parallel Female BSPP					
HQPM2	1/8 in. Female PF	HQPM2-FIP-1/8	28.4 (1.12)	66.0 (2.60)	5/8
	1/4 in. Female PF	HQPM2-FIP-1/4	28.4 (1.12)	75.9 (2.99)	3/4
HQPM4	1/4 in. Female PF	HQPM4-FIP-1/4	44.0 (1.73)	85.1 (3.35)	15/16
HQPM8	1/2 in. Female PF	HQPM8-FIP-1/2	50.8 (4.30)	89.7 (3.53)	1-1/4

Bulkhead Bodies

Compression Tube Fitting

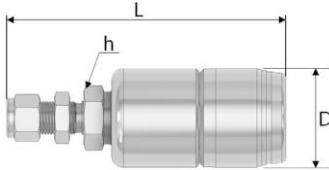

Integral Bulkhead

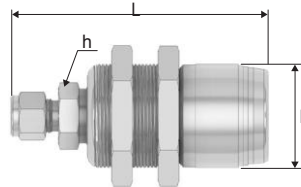

Series	End Connection	Basic Ordering Number	D mm (in.)	L mm (in.)	h Hex. In	Panel Hole Drill size mm (in.)	Panel Max Thickness mm (in.)
Compression Tube Fitting							
HQPM2	1/4 in. Compression	HQPM2-C-1/4-B	28.4 (1.12)	80.3 (3.16)	5/8	30.6 (1.20)	16.5 (0.65)
	6 mm Compression	HQPM2-C-6M-B	28.4 (1.12)	80.3 (3.16)	15mm	30.6 (1.20)	16.5 (0.65)
HQPM4	1/4 in. Compression	HQPM4-C-1/4-B	44.0 (1.73)	119.0 (4.68)	15/16	11.7 (0.46)	3.8 (0.15)
	3/8 in. Compression	HQPM4-C-3/8-B	44.0 (1.73)	122.0 (4.80)	15/16	14.7 (0.58)	3.8 (0.15)
	6 mm Compression	HQPM4-C-6M-B	44.0 (1.73)	119.0 (4.68)	24mm	11.7 (0.46)	3.8 (0.15)
	10 mm Compression	HQPM4-C-10M-B	44.0 (1.73)	122.0 (4.80)	24mm	16.8 (0.66)	3.8 (0.15)
HQPM8	1/2 in. Compression	HQPM8-C-1/2-B	50.8 (4.30)	130.0 (5.11)	1-1/4	19.6 (0.77)	4.8 (0.19)
	12 mm Compression	HQPM8-C-12M-B	50.8 (4.30)	130.0 (5.11)	32mm	19.6 (0.77)	4.8 (0.19)

Insertion depth

To have an overall length in coupled position, subtract the insertion depth from the combination length of the stem and the body.

Series	Depth mm (in.)
HQPM2	0.9(23.5)
HQPM4	1.1(27.2)
HQPM8	1.2(30.6)

Ordering Information and Dimensions Stems

Stems

Compression Tube Fitting

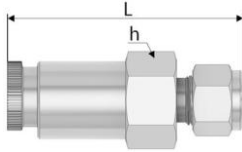

SV : Stem has no valve

DV : Stem has a valve

Series	End Connection	Basic Ordering Number		Cv		L mm (in.)	h Hex. In
		SV	DV	SV	DV		
Compression Tube Fitting							
HQPM2	1/4 in. Compression	HQPM2S-C-1/4	HQPM2D-C-1/4	0.7	0.6	51.1 (2.01)	5/8
	3/8 in. Compression	HQPM2S-C-3/8	HQPM2D-C-3/8	0.9	0.8	52.6 (2.07)	11/16
	6 mm Compression	HQPM2S-C-6M	HQPM2D-C-6M	0.7	0.6	51.1 (2.01)	16mm
	8 mm Compression	HQPM2S-C-8M	HQPM2D-C-8M	0.9	0.8	53.1 (2.09)	16mm
HQPM4	1/4 in. Compression	HQPM4S-C-1/4	HQPM4D-C-1/4	0.9	0.8	66.3 (2.61)	15/16
	3/8 in. Compression	HQPM4S-C-3/8	HQPM4D-C-3/8	1.7	1.6	67.8 (2.67)	15/16
	6 mm Compression	HQPM4S-C-6M	HQPM4D-C-6M	0.9	0.8	66.3 (2.61)	5/8
	10 mm Compression	HQPM4S-C-10M	HQPM4D-C-10M	1.7	1.6	68.1 (2.68)	24mm
HQPM8	1/2 in. Compression	HQPM8S-C-1/2	HQPM8D-C-1/2	4.2	3.1	77.7 (3.06)	1-5/16
	3/4 in. Compression	HQPM8S-C-3/4	HQPM8D-C-3/4	6.7	6.4	77.7 (3.06)	1-5/16
	1 in. Compression	HQPM8S-C-1.0	HQPM8D-C-1.0	9.0	7.8	83.1 (3.27)	1-3/8
	12 mm Compression	HQPM8S-C-12M	HQPM8D-C-12M	4.2	3.1	77.7 (3.06)	35mm

Female NPT / BSPT / BSPP

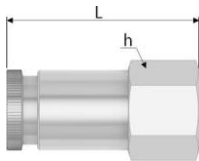

Series	End Connection	Basic Ordering Number		Cv		L mm (in.)	h Hex. In
		SV	DV	SV	DV		
Female NPT							
HQPM2	1/4 in. Female NPT	HQPM2S-F-1/4	HQPM2D-F-1/4	0.2	0.2	48.5 (1.91)	5/8
	3/8 in. Female NPT	HQPM2S-F-3/8	HQPM2D-F-3/8	0.7	0.6	51.8 (2.04)	11/16
HQPM4	1/4 in. Female NPT	HQPM4S-F-1/4	HQPM4D-F-1/4	1.4	1.4	62.5 (2.46)	15/16
	3/8 in. Female NPT	HQPM4S-F-3/8	HQPM4D-F-3/8	1.8	1.7	62.5 (2.46)	15/16
HQPM8	1/2 in. Female NPT	HQPM8S-F-1/2	HQPM8D-F-1/2	5.1	4.4	70.6 (2.78)	1-5/16
	3/4 in. Female NPT	HQPM8S-F-3/4	HQPM8D-F-3/4	8.5	7.8	70.6 (2.78)	1-5/16
	1 in. Female NPT	HQPM8S-F-1.0	HQPM8D-F-1.0	-	-	77.0 (3.03)	1-5/8
ISO Tapered Female BSPT							
HQPM2	1/4 in. Female PT	HQPM2S-FIT-1/4	HQPM2D-FIT-1/4	0.2	0.2	48.5 (1.91)	5/8
HQPM4	1/4 in. Female PT	HQPM4S-FIT-1/4	HQPM4D-FIT-1/4	1.4	1.4	62.5 (2.46)	15/16
HQPM8	1/2 in. Female PT	HQPM8S-FIT-1/2	HQPM8D-FIT-1/2	5.1	4.4	70.6 (2.78)	1-5/16
ISO Parallel Female BSPP							
HQPM2	1/8 in. Female PF	HQPM2S-FIP-1/8	HQPM2D-FIP-1/8	0.5	0.4	48.5 (1.91)	5/8
	1/4 in. Female PF	HQPM2S-FIP-1/4	HQPM2D-FIP-1/4	0.6	0.6	48.5 (1.91)	3/4
HQPM4	1/4 in. Female PF	HQPM4S-FIP-1/4	HQPM4D-FIP-1/4	1.2	1.2	63.0 (2.48)	15/16
HQPM8	1/2 in. Female PF	HQPM8S-FIP-1/2	HQPM8D-FIP-1/2	4.8	3.9	70.6 (2.78)	1-5/16

Ordering Information and Dimensions Stems

Stems

Male NPT / BSPT

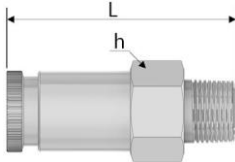

SV : Stem has no valve

DV : Stem has a valve

Series	End Connection	Basic Ordering Number		Cv		L mm (in.)	h Hex. In
		SV	DV	SV	DV		
Male NPT							
HQPM2	1/4 in. Male NPT	HQPM2S-M-1/8	HQPM2D-M-1/8	0.2	0.2	48.5 (1.91)	5/8
	3/8 in. Male NPT	HQPM2S-M-3/8	HQPM2D-M-3/8	0.7	0.6	51.8 (2.04)	1 1/16
HQPM4	1/4 in. Male NPT	HQPM4S-M-1/4	HQPM4D-M-1/4	1.4	1.4	62.5 (2.46)	1 5/16
	3/8 in. Male NPT	HQPM4S-M-3/8	HQPM4D-M-3/8	1.8	1.7	62.5 (2.46)	1 5/16
HQPM8	1/2 in. Male NPT	HQPM8S-M-1/2	HQPM8D-M-1/2	5.1	4.4	70.6 (2.78)	1 -5/16
	3/4 in. Male NPT	HQPM8S-M-3/4	HQPM8D-M-3/4	8.5	7.8	70.6 (2.78)	1 -5/16
	1 in. Male NPT	HQPM8S-M-1.0	HQPM8D-M-1.0	-	-	77.0 (3.03)	1 -5/8
ISO Tapered Male BSPT							
HQPM2	1/4 in. Male PT	HQPM2S-IT-1/4	HQPM2D-IT-1/4	0.2	0.2	48.5 (1.91)	5/8
HQPM4	1/4 in. Male PT	HQPM4S-IT-1/4	HQPM4D-IT-1/4	1.4	1.4	62.5 (2.46)	15/16
HQPM8	1/2 in. Male PT	HQPM8S-IT-1/2	HQPM8D-IT-1/2	5.1	4.4	70.6 (2.78)	1-5/16

Male BSPP

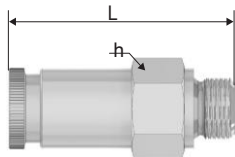

Series	End Connection	Basic Ordering Number		Cv		L mm (in.)	h Hex. In
		SV	DV	SV	DV		
ISO Parallel Male BSPP							
HQPM2	1/8 in. Male PF	HQPM2S-IP-1/8	HQPM2D-IP-1/8	0.5	0.4	48.5 (1.91)	5/8
	1/4 in. Male PF	HQPM2S-IP-1/4	HQPM2D-IP-1/4	0.6	0.6	48.5 (1.91)	3/4
HQPM4	1/4 in. Male PF	HQPM4S-IP-1/4	HQPM4D-IP-1/4	1.2	1.2	63.0 (2.48)	15/16
HQPM8	1/2 in. Male PF	HQPM8S-IP-1/2	HQPM8D-IP-1/2	4.8	3.9	70.6 (2.78)	1-5/16

Male JIC 37°

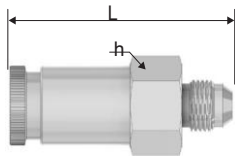

Series	End Connection	Basic Ordering Number		Cv		L mm (in.)	h Hex. In
		SV	DV	SV	DV		
Male JIC 37° Flare							
HQPM4	1/4 in. AN Flare	HQPM4S-AN-1/4	HQPM4D-AN-1/4	-	-	63.0 (2.48)	15/16
HQPM8	1/2 in. AN Flare	HQPM8S-AN-1/2	HQPM8D-AN-1/2	4.2	2.7	70.6 (2.78)	1-5/16

How to Order

HQPM series consists of a DV or SV stem and body

Examples: HQPM-8D-D8T-S(DV) or HQPM-8S-D8T-S(SV) and HQP-M8-D8T-S(Body)

HQPM color coded “Keyed” quick connect



Key Color	Key Number and Designator
Black	K1
Orange	K2
Green	K3
Yellow	K4
Blue	K5
White	K6
Purple	K7
Brown	K8

Features

- HQPM Keyed quick connect prevent intermixing of different keys mechanically as well as allow visual identification by color coding.
- Eight (8) different keys on each HQPM series are available with its own Key number.
- HQPM keys are useful to control multi-fluid or multi-pressure systems.
- If an attempt is made to couple unlike keys, the valve system will not open.

Operation

- Select stem and body keyed in the same HQPM series.
- Coupling: Align stem with body. Push stem into body until it clicks.
- Uncoupling: Pull body sleeve toward stem. Remove stem.
- If an attempt is made to couple unlike keys, the valve system will not open.

How to Order

Add the key number as a suffix to the HQPM series Ordering Number.

Examples: HQP-M8-D8T-K1-S, HQPM-8D-D-8T-K1-S

HQPM2 and HQPM4 series quick connect are available in keys K1 through K8.

HQPM8 series quick connects are available in keys K1 through K4 only.